

REAM LINE



# High Quality Tools, high performance and reliability

*Herramientas de alta calidad, alto rendimiento y confiabilidad.*

**Development and production of precision tools** for different industry sectors and active participation in the global market with the main segment of EndMills, Drills and Taps. *Desarrollo y producción de herramientas de precisión para los diferentes sectores de la industria y participación en el mercado global con el segmento principal de fresas, brocas y machos de roscar.*

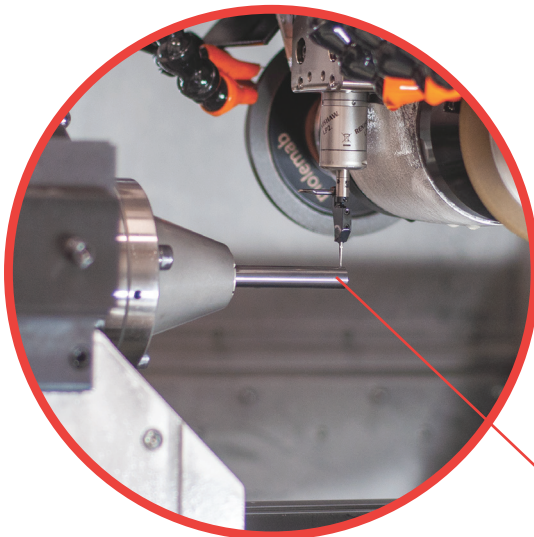

**High standards of quality and dimensional tolerance** allow them to obtain the best results in the machining processes in the automotive, aeronautical, construction, structural engineering, mold and die sectors. *Altos estándares de calidad y tolerancia dimensional les permiten obtener los mejores resultados en los procesos de mecanizado en sectores de la industria automotriz, aeronáutica, construcción, ingeniería estructural, molde y matriz.*



# Quality, Innovation and Service for a Higher Performance Production

*Calidad, Innovación y servicio para una producción con mayor rendimiento*

- ✓ High quality raw material  
Materia prima de alta calidad
- ✓ Latest technology applied to our coatings  
Última tecnología en recubrimientos.
- ✓ Maximum performance with optimized geometries  
Rendimiento máximo con geometrías optimizadas.
- ✓ High-precision manufacturing and quality control with state-of-the-art machines  
Fabricación de alta precisión y control de calidad con máquinas de última tecnología.
- ✓ Research and development in all our product categories  
Investigación y desarrollo en todas las categorías de producto
- ✓ Environmentally-friendly production, recycling as a commitment to the planet  
Producción verde, el reciclaje como compromiso con el planeta.



## SOLID CARBIDE CNC MACHINE REAMER

Escariador de máquina CNC en metal duro integral

# 28.1202

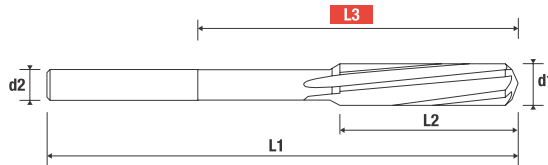

Cod.	d1	d2	L1	L2	L3
2812020300	3,0	4	64	24	36
2812020350	3,5	4	74	28	46
2812020400	4,0	6	82	32	50
2812020450	4,5	6	82	32	50
2812020500	5,0	6	93	35	59
2812020550	5,5	6	93	35	57
2812020600	6,0	6	93	38	57
2812020650	6,5	8	101	38	63
2812020700	7,0	8	109	43	69
2812020750	7,5	8	109	43	69
2812020800	8,0	8	117	46	75
2812020900	9,0	10	125	49	81
2812020950	9,5	10	125	49	81
2812021000	10,0	10	133	51	87
2812021050	10,5	10	133	51	87
2812021100	11,0	10	142	55	96
2812021200	12,0	12	151	58	105

Application example fixing pins DIN 6325 for d1 = 8  
Use drill D:7,80 and then reamer 28.1202 or 25.0200 D: 8 H7

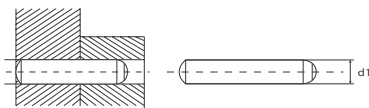

C. CONDITIONS



### SC

**h7**  
TOLERANCE

BRIGHT

**55**  
HRC



**GG(G)**

NI  
ALLOYS

**TITAN**  
INCONEL

INOX

PLASTIC

UNI

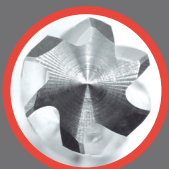

Helion



## 29.1502

## SOLID CARBIDE CNC MACHINE REAMER

Escariador de máquina CNC en metal duro integral

SC

BRIGHT

55  
HRC

600  
1200  
N/mm<sup>2</sup>



GG(G)

INOX

ALU  
NE

UNI



HA

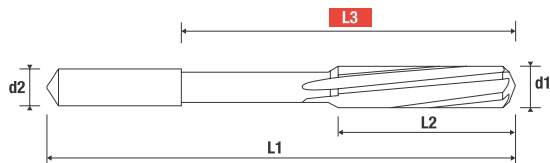

Cod.	d1	d2	L1	L2	L3	Z
2915020098	0,98	4	50	6	22	3
2915020099	0,99	4	50	6	22	3
2915020100	1,00	4	50	6	22	3
2915020101	1,01	4	50	6	22	3
2915020102	1,02	4	50	6	22	3
2915020103	1,03	4	50	9	22	3
2915020148	1,48	4	50	9	22	3
2915020149	1,49	4	50	9	22	3
2915020150	1,50	4	50	9	22	3
2915020151	1,51	4	50	9	22	3
2915020152	1,52	4	50	9	22	3
2915020153	1,53	4	50	9	22	3
2915020198	1,98	4	50	12	22	4
2915020199	1,99	4	50	12	22	4
2915020200	2,00	4	50	12	22	4
2915020201	2,01	4	50	12	22	4
2915020202	2,02	4	50	12	22	4
2915020203	2,03	4	50	12	22	4
2915020248	2,48	4	60	16	32	4
2915020249	2,49	4	60	16	32	4
2915020250	2,50	4	60	16	32	4
2915020251	2,51	4	60	16	32	4
2915020252	2,52	4	60	16	32	4
2915020253	2,53	4	60	16	32	4

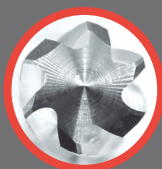

Helion

Helion

Cod.	d1	d2	L1	L2	L3	Z
2915020297	2,97	4	64	17	36	6
2915020298	2,98	4	64	17	36	6
2915020299	2,99	4	64	17	36	6
2915020300	3,00	4	64	17	36	6
2915020301	3,01	4	64	17	36	6
2915020302	3,02	4	64	17	36	6
2915020303	3,03	4	64	17	36	6
2915020397	3,97	4	77	21	45	6
2915020398	3,98	4	77	21	45	6
2915020399	3,99	4	77	21	45	6
2915020400	4,00	4	77	21	45	6
2915020401	4,01	4	77	21	45	6
2915020402	4,02	4	77	21	45	6
2915020403	4,03	4	77	21	45	6
2915020497	4,97	6	93	26	59	6
2915020498	4,98	6	93	26	59	6
2915020499	4,99	6	93	26	59	6
2915020500	5,00	6	93	26	59	6
2915020501	5,01	6	93	26	59	6
2915020502	5,02	6	93	26	59	6
2915020503	5,03	6	93	26	59	6
2915020597	5,97	6	93	26	57	6
2915020598	5,98	6	93	26	57	6
2915020599	5,99	6	93	26	57	6
2915020600	6,00	6	93	26	57	6
2915020601	6,01	6	93	26	57	6
2915020602	6,02	6	93	26	57	6
2915020603	6,03	6	93	26	57	6

Cod.	d1	d2	L1	L2	L3	Z
2915020700	7,00	8	109	31	69	6
2915020797	7,97	8	117	33	75	6
2915020798	7,98	8	117	33	75	6
2915020799	7,99	8	117	33	75	6
2915020800	8,00	8	117	33	75	6
2915020801	8,01	8	117	33	75	6
2915020802	8,02	8	117	33	75	6
2915020803	8,03	8	117	33	75	6
2915020804	8,04	8	117	33	75	6
2915020900	9,00	10	125	36	81	6
2915020997	9,97	10	133	38	87	6
2915020998	9,98	10	133	38	87	6
2915020999	9,99	10	133	38	87	6
2915021000	10,00	10	133	38	87	6
2915021001	10,01	10	133	38	87	6
2915021002	10,02	10	133	38	87	6
2915021003	10,03	10	133	38	87	6
2915021004	10,04	10	133	38	87	6
2915021005	10,05	10	133	38	87	6
2915021197	11,97	12	151	44	105	6
2915021198	11,98	12	151	44	105	6
2915021199	11,99	12	151	44	105	6
2915021200	12,00	12	151	44	105	6
2915021201	12,01	12	151	44	105	6
2915021202	12,02	12	151	44	105	6
2915021203	12,03	12	151	44	105	6
2915021204	12,04	12	151	44	105	6
2915021205	12,05	12	151	44	105	6



Tolerance	Diameter range
- 0 / + 0,004	Ø < 5,50 mm
- 0 / + 0,005	Ø ≥ 5,50 mm

Ø > 3,75 mm unequal division

Application example ejector pin DIN 1530 for d1 = 8  
Use drill D:7,80 and then reamer 29.1502 D: 7,98



C. CONDITIONS



## 25.0200

### HSS-E



## HSS-E CNC MACHINE REAMER

Escariador de máquina CNC en acero rápido

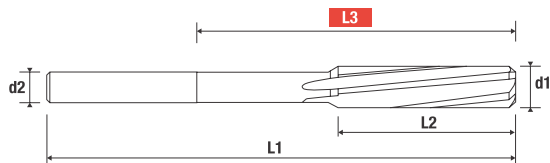

Cod.	d1	d2	L1	L2	L3
2502000380	3,8	4,0	75	19	47
2502000390	3,9	4,0	75	19	47
2502000400	4,0	4,0	75	19	47
2502000410	4,1	4,0	75	19	47
2502000420	4,2	4,0	75	19	47
2502000430	4,3	4,5	80	21	52
2502000440	4,4	4,5	80	21	52
2502000450	4,5	4,5	80	21	52
2502000460	4,6	4,5	80	21	52
2502000470	4,7	4,5	80	21	52
2502000480	4,8	5,0	86	23	58
2502000490	4,9	5,0	86	23	58
2502000500	5,0	5,0	86	23	58
2502000510	5,1	5,0	86	23	58
2502000520	5,2	5,0	86	23	58
2502000530	5,3	5,0	86	23	58
2502000540	5,4	5,6	93	26	57
2502000550	5,5	5,6	93	26	57
2502000560	5,6	5,6	93	26	57
2502000570	5,7	5,6	93	26	57
2502000580	5,8	5,6	93	26	57
2502000590	5,9	5,6	93	26	57
2502000600	6,0	5,6	93	26	57
2502000610	6,1	6,3	101	28	65

Cod.	d1	d2	L1	L2	L3
2502000620	6,2	6,3	101	28	65
2502000630	6,3	6,3	101	28	65
2502000640	6,4	6,3	101	28	65
2502000650	6,5	6,3	101	28	65
2502000660	6,6	6,3	101	28	65
2502000670	6,7	6,3	101	28	65
2502000680	6,8	7,1	109	31	73
2502000690	6,9	7,1	109	31	73
2502000700	7,0	7,1	109	31	73
2502000710	7,1	7,1	109	31	73
2502000720	7,2	7,1	109	31	73
2502000730	7,3	7,1	109	31	73
2502000740	7,4	7,1	109	31	73
2502000750	7,5	7,1	109	31	73
2502000760	7,6	8,0	117	33	81
2502000770	7,7	8,0	117	33	81
2502000780	7,8	8,0	117	33	81
2502000790	7,9	8,0	117	33	81
2502000800	8,0	8,0	117	33	81
2502000810	8,1	8,0	117	33	81
2502000820	8,2	8,0	117	33	81
2502000830	8,3	8,0	117	33	81
2502000840	8,4	8,0	117	33	81
2502000850	8,5	8,0	117	33	81
2502000860	8,6	9,0	125	36	85
2502000870	8,7	9,0	125	36	85
2502000880	8,8	9,0	125	36	85
2502000890	8,9	9,0	125	36	85
2502000900	9,0	9,0	125	36	85
2502000910	9,1	9,0	125	36	85
2502000920	9,2	9,0	125	36	85
2502000930	9,3	9,0	125	36	85
2502000940	9,4	9,0	125	36	85
2502000950	9,5	9,0	125	36	85
2502000960	9,6	10,0	133	38	93
2502000970	9,7	10,0	133	38	93
2502000980	9,8	10,0	133	38	93
2502000990	9,9	10,0	133	38	93

Cod.	d1	d2	L1	L2	L3
2502001000	10,0	10,0	133	38	93
2502001010	10,1	10,0	133	38	93
2502001020	10,2	10,0	133	38	93
2502001030	10,3	10,0	133	38	93
2502001040	10,4	10,0	133	38	93
2502001070	10,7	10,0	142	41	102
2502001080	10,8	10,0	142	41	102
2502001100	11,0	10,0	142	41	102
2502001150	11,5	10,0	142	41	102
2502001190	11,9	10,0	151	44	111
2502001200	12,0	10,0	151	44	111
2502001300	13,0	10,0	151	44	111
2502001400	14,0	12,5	160	47	115
2502001500	15,0	12,5	162	50	117
2502001600	16,0	12,5	170	52	125
2502001700	17,0	14,0	175	54	130
2502001800	18,0	14,0	182	56	137
2502001900	19,0	16,0	189	58	141
2502002000	20,0	16,0	195	60	147



C. CONDITIONS



## 25.1500

HSS-E



## HIGH PERFORMANCE CNC MACHINE REAMER - GAMMON

Escariador de máquina de alto rendimiento - Gammon

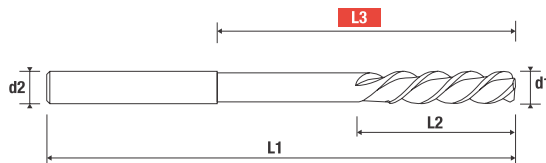

Cod.	d1	d2	L1	L2	L3
2515000400	4,0	4,0	75	19	47
2515000450	4,5	4,5	80	21	52
2515000500	5,0	5,0	86	23	58
2515000550	5,5	5,6	93	26	57
2515000600	6,0	5,6	93	26	57
2515000650	6,5	6,3	101	28	65
2515000700	7,0	7,1	109	31	73
2515000800	8,0	8,0	117	33	81
2515000850	8,5	8,0	117	33	81
2515000900	9,0	9,0	125	36	85
2515001000	10,0	10,0	133	38	93
2515001100	11,0	10,0	142	41	102
2515001200	12,0	10,0	151	44	111
2515001300	13,0	10,0	151	44	111
2515001400	14,0	12,5	160	47	115
2515001500	15,0	12,5	162	50	117
2515001600	16,0	12,5	170	52	125
2515001700	17,0	14,0	175	54	130
2515001800	18,0	14,0	182	56	137
2515002000	20,0	16,0	195	60	147



C. CONDITIONS



APPLICATION



Helion

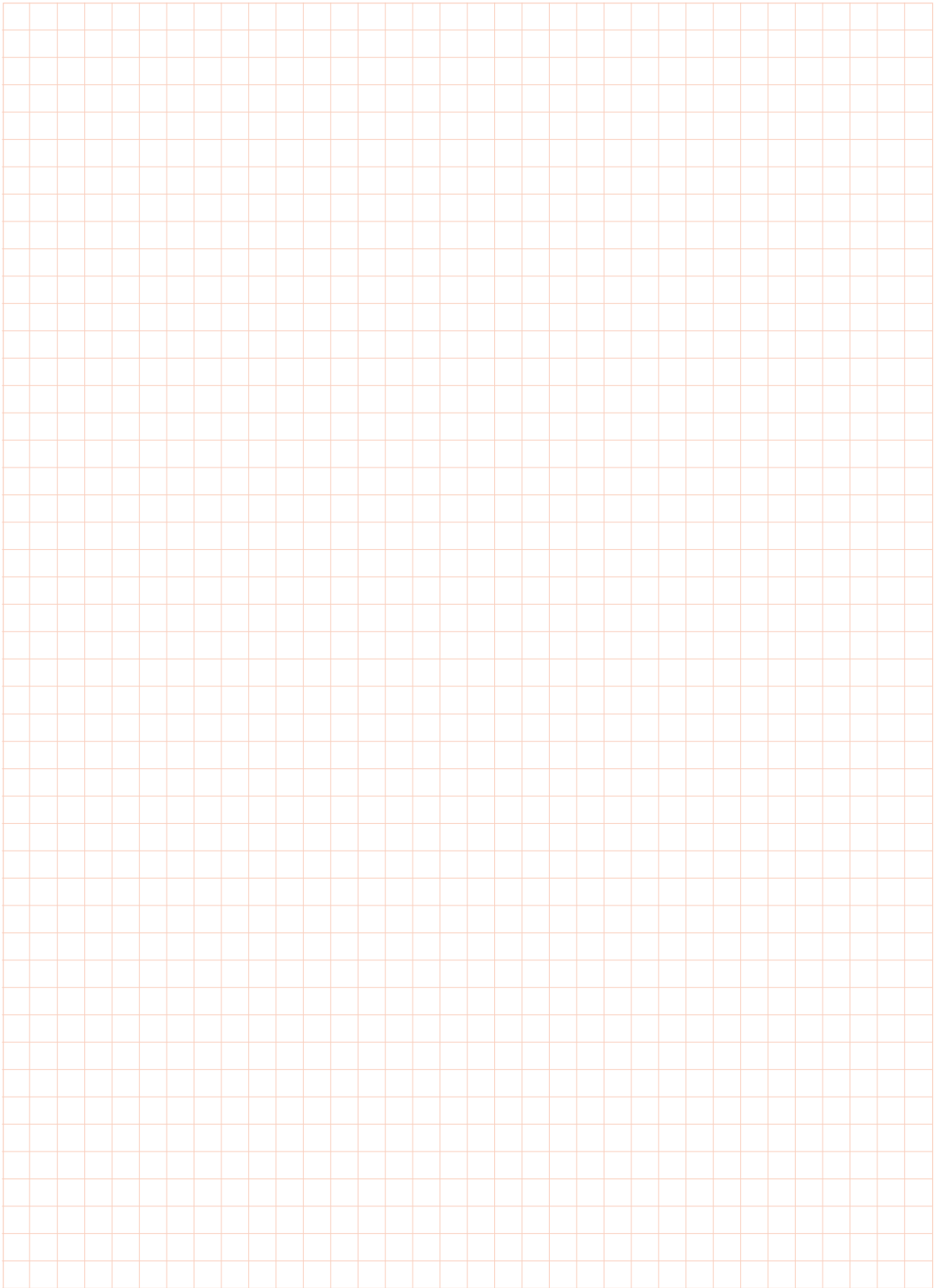





WORKING FOR YOUR  
SUCCESS SINCE 1952  
[www.helion.tools](http://www.helion.tools)  
[@heliontools](https://twitter.com/heliontools)



HELION TOOLS S.L.U  
Calle Miquel Servet 37 Nave 13  
Polígono industrial Bufalvent  
08243 Manresa · Barcelona · España  
+34 93 877 08 69 · [info@helion-tools.com](mailto:info@helion-tools.com)